

FOR SALE
+ / - 3,120 SF ON
.25 ACRES
108 W. Division Street
Mt. Juliet, TN 37122

Size:

+/- 3,120 SF on +/- .25 Acres

Location: Two miles north of I-40, Exit 226, Adjacent to TN Central RR

Parcel ID Wilson County
 Mt. Juliet 072I C 010.00

Zoning: Commercial Town Center

Year Built: 1938

Floor System: Slab on grade

Floor Finish: Concrete

Exterior Wall: Concrete block

Structural Framing: Masonry

Roll Up Door: 10' W x 10.5' H

Roof: Metal

Building shape: Rectangular design (approx. 40' D x 70' W)

Spray Booth: 12' W x 14' H roll up door access

Air Compressor 5 HP included

Wilson County Taxes: \$597.18

Utilities: Water, sewer, gas are available

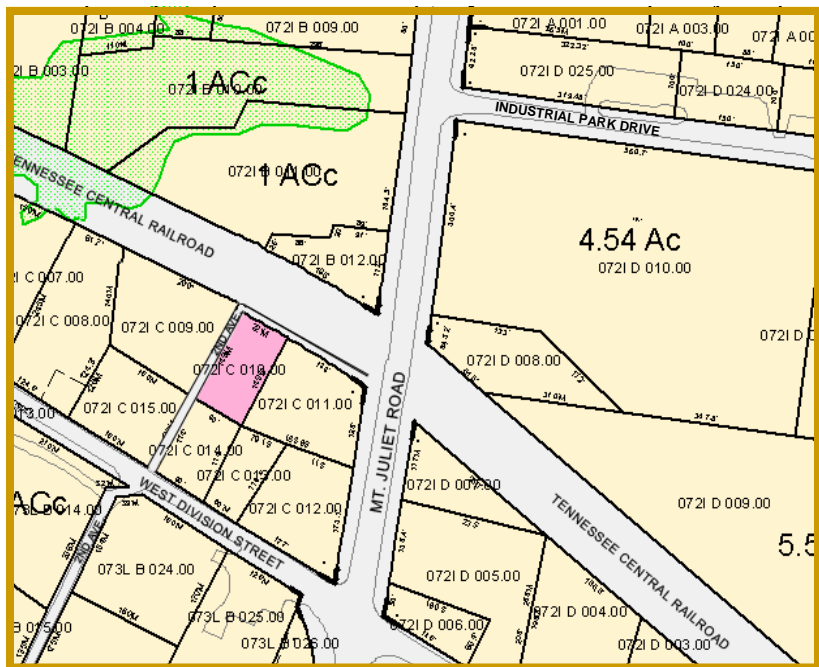

Exclusively Listed By:

David B. Jacobs / Carl Dreifuss
 Mobile 615.218.7500 (David)
 Mobile 615.804.5893 (Carl)
 djacobs@KarrCommercial.com
 cdreifuss@KarrCommercial.com

108 W. Division St.
Mt. Juliet, TN 37122



Karr Commercial, LLC 5633 Charlotte Avenue, Suite 201 Nashville, Tennessee 37209 615-321-5555 615-352-1414 fax